

Lima One

The radiator has a built-in ONE heating element.

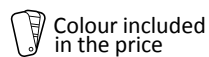

design: *Terma*

Connections:

A ↓ 500÷1700:

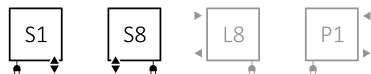

A ↓ 820÷1700:

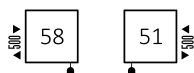

Electric radiators:

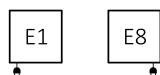

We recommend:

A set of integrated thermostatic valves with immersion tube for S1 and S8 connections



Integrated pipe-masking set

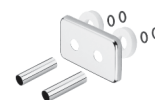

Specifications:

Working pressure: 1,0 MPa Maximum operating temperature: 82°C

A ↓	B ↔	C5 [mm]	75/65/20°C [W]	55/45/20°C [W]	[W]	D [mm]	E [mm]	F [mm]	[dm³]	[kg]	Product Code Configuration codes: 5
Powder coating											
500	300	-	144	79	120	270	320	90	1,43	2,94	WZLIE050030
500	400	-	192	105	200	370	320	90	1,73	3,58	WZLIE050040
500	500	-	241	131	200	470	320	90	2,03	4,22	WZLIE050050
500	600	-	282	153	300	570	320	90	2,33	4,86	WZLIE050060
500	700	-	324	176	300	670	320	90	2,62	5,50	WZLIE050070
500	1000	-	482	262	400	970	320	90	3,52	7,43	WZLIE050100
500	1200	-	578	314	600	1170	320	90	4,12	8,71	WZLIE050120
820	300	500	244	132	300	270	640	90	2,47	4,94	WZLIE082030
820	400	500	325	175	300	370	640	90	3,01	6,10	WZLIE082040
820	500	500	406	218	400	470	640	90	3,54	7,25	WZLIE082050
820	600	500	477	256	400	570	640	90	4,08	8,40	WZLIE082060
820	700	500	547	293	600	670	640	90	4,62	9,55	WZLIE082070
1140	300	500	345	185	400	270	960	90	3,51	6,94	WZLIE114030
1140	400	500	460	247	400	370	960	90	4,28	8,61	WZLIE114040
1140	500	500	574	308	600	470	960	90	5,06	10,27	WZLIE114050
1140	600	500	675	361	800	570	960	90	5,84	11,94	WZLIE114060
1140	700	500	776	415	800	670	960	90	6,61	13,61	WZLIE114070

Lima One

The radiator has a built-in ONE heating element.



Colour included in the price

A ↓	B ↔	C5 [mm]	75/65/20°C [W]	55/45/20°C [W]	[W]	D [mm]	E [mm]	F [mm]	H [dm³]	[kg]	Product Code <small>Configuration codes: 5</small>
1460	300	500	449	240	400	270	1280	90	4,60	9,06	WZLIE146030
1460	400	500	599	319	600	370	1280	90	5,61	11,24	WZLIE146040
1460	500	500	748	399	800	470	1280	90	6,63	13,41	WZLIE146050
1460	600	500	879	468	800	570	1280	90	7,64	15,59	WZLIE146060
1460	700	500	1009	537	1000	670	1280	90	8,66	17,77	WZLIE146070
1700	300	500	527	280	600	270	1520	90	5,40	10,62	WZLIE170030
1700	400	500	703	374	800	370	1520	90	6,60	13,18	WZLIE170040
1700	500	500	878	466	800	470	1520	90	7,79	15,74	WZLIE170050
1700	600	500	1031	547	1000	570	1520	90	8,99	18,30	WZLIE170060

Plated finishes

500	300	-	101	51	120	270	320	90	1,43	2,94	WZLIE050030
500	400	-	134	69	120	370	320	90	1,73	3,58	WZLIE050040
500	500	-	169	86	200	470	320	90	2,03	4,22	WZLIE050050
500	600	-	197	101	200	570	320	90	2,33	4,86	WZLIE050060
500	700	-	227	116	200	670	320	90	2,62	5,50	WZLIE050070
500	1000	-	337	172	400	970	320	90	3,52	7,43	WZLIE050100
500	1200	-	405	206	400	1170	320	90	4,12	8,71	WZLIE050120
500	1400	-	473	241	400	1370	320	90	4,72	9,99	WZLIE050140
820	300	500	171	87	200	270	640	90	2,47	4,94	WZLIE082030
820	400	500	228	116	200	370	640	90	3,01	6,10	WZLIE082040
820	500	500	284	145	300	470	640	90	3,54	7,25	WZLIE082050
820	600	500	334	170	400	570	640	90	4,08	8,40	WZLIE082060
820	700	500	383	195	400	670	640	90	4,62	9,55	WZLIE082070
1140	300	500	242	123	300	270	960	90	3,51	6,94	WZLIE114030
1140	400	500	322	164	300	370	960	90	4,28	8,61	WZLIE114040
1140	500	500	402	205	400	470	960	90	5,06	10,27	WZLIE114050
1140	600	500	473	241	400	570	960	90	5,84	11,94	WZLIE114060
1140	700	500	543	277	600	670	960	90	6,61	13,61	WZLIE114070
1460	300	500	314	160	300	270	1280	90	4,60	9,06	WZLIE146030
1460	400	500	419	214	400	370	1280	90	5,61	11,24	WZLIE146040
1460	500	500	524	267	600	470	1280	90	6,63	13,41	WZLIE146050
1460	600	500	615	314	600	570	1280	90	7,64	15,59	WZLIE146060
1460	700	500	706	360	800	670	1280	90	8,66	17,77	WZLIE146070
1700	300	500	369	188	400	270	1520	90	5,40	10,62	WZLIE170030
1700	400	500	492	251	600	370	1520	90	6,60	13,18	WZLIE170040
1700	500	500	615	313	600	470	1520	90	7,79	15,74	WZLIE170050
1700	600	500	722	368	800	570	1520	90	8,99	18,30	WZLIE170060
1700	700	500	828	422	800	670	1520	90	10,18	20,86	WZLIE170070

Lima One

The radiator has a built-in ONE heating element.

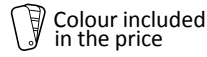

Colour included in the price

Available sizes:

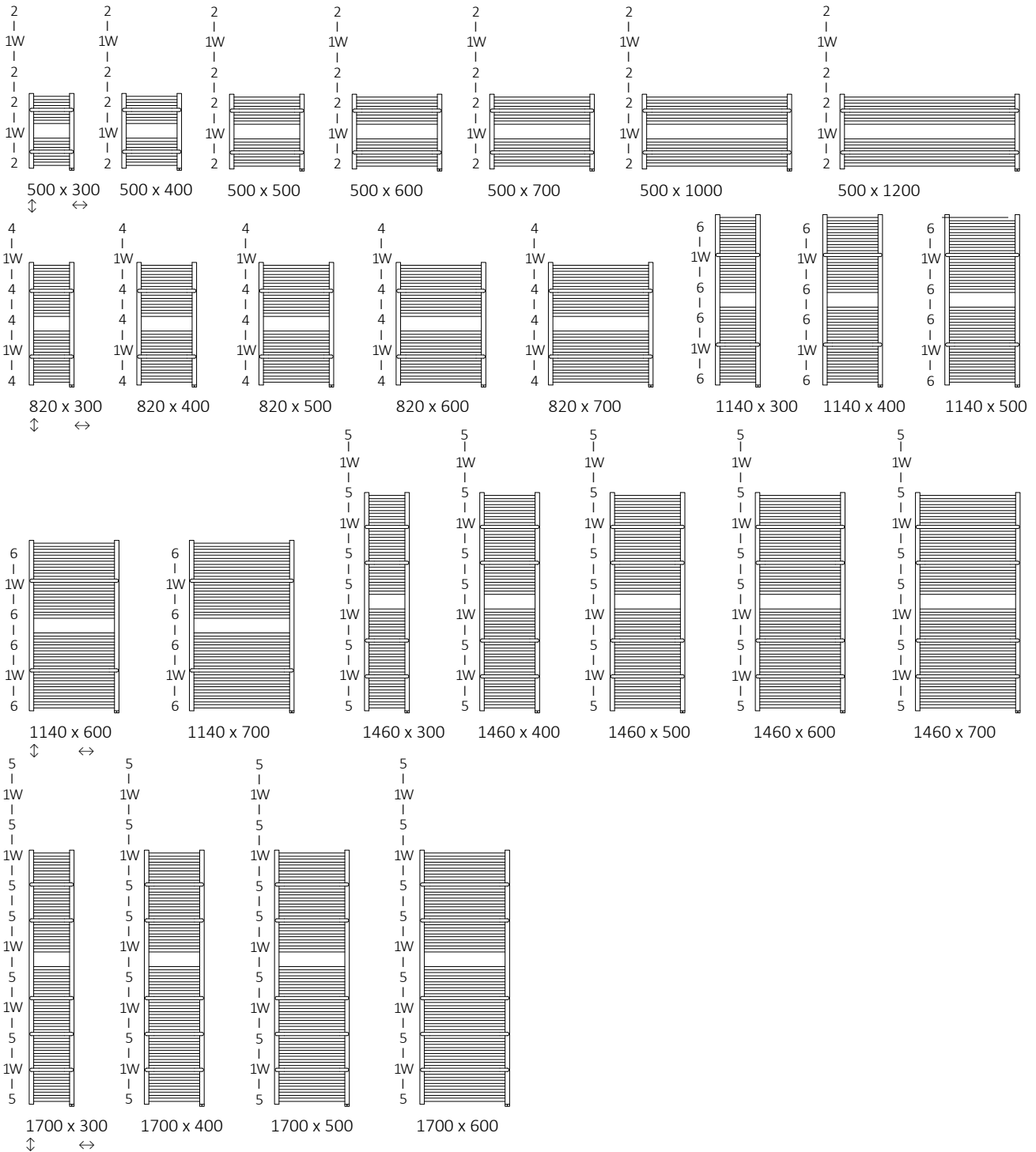

Lima One

The radiator has a built-in ONE heating element.



Colour included in the price

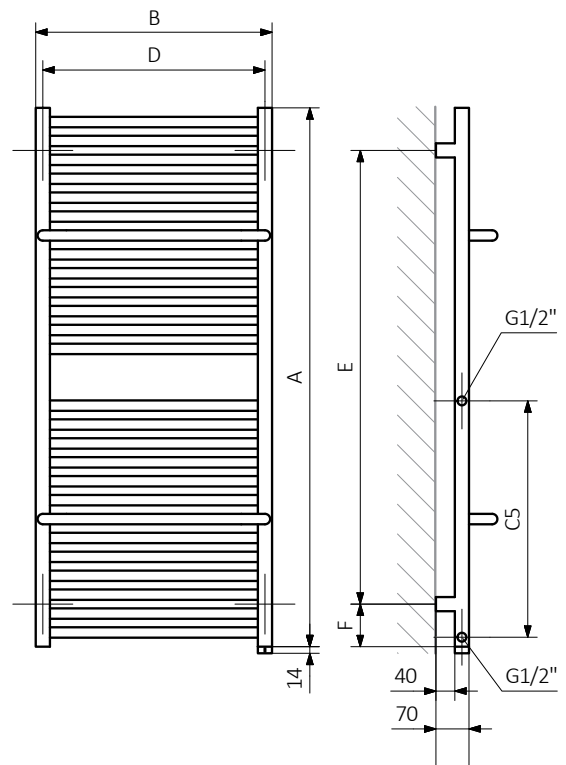
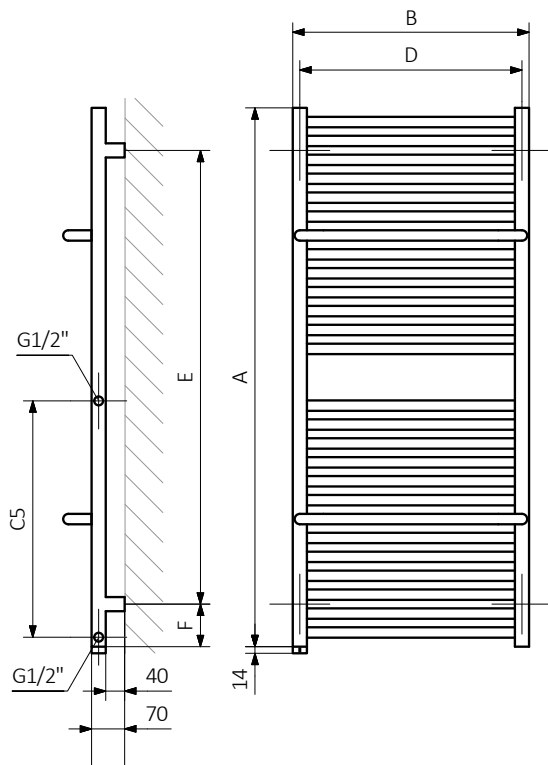
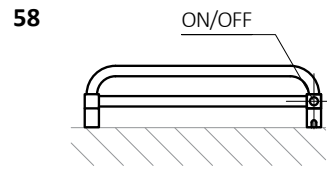
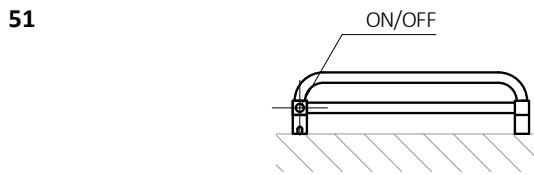
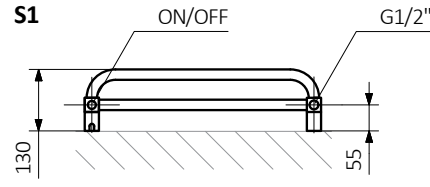
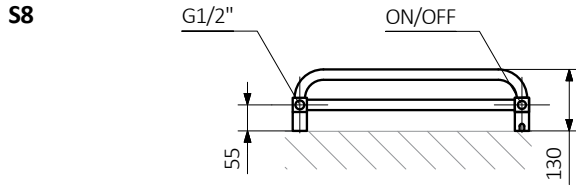

A — Height B — Width C1-C5 — Distance between pipe centres D — Horizontal distance between mounting bracket centres
E — Vertical distance between mounting brackets F — Distance between a mounting bracket and the bottom of the radiator

Collector:

Profile:

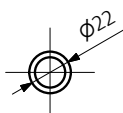
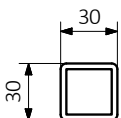

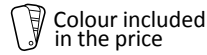

Product codes can be found in product data sheet tables. The codes provide some basic information about the product while a partially filled configuration code contains complementary information about the detailed specifications. When placing an order, product codes should include the fully completed configuration part. The configuration code part should be placed after the main product code. The main product code and configuration part will appear as shown in the example below:

The Construction of the product and configuration code for a radiator with the built-in heating element ONE

WWBNN076050

K916E1W

PRODUCT CODE
(located in the table for the product)

CONFIGURATION CODE
(supplemented by hand)

Configuration

K 916 E1 P

Package code Colour code Connection code Type of heating element cable code
K – carton box

Zinc powder primer

C – Code of zinc powder primer is an extra processes

WLAL054030 K916SX **C** – *Extra processes or additions code*

Lima One

The radiator has a built-in ONE heating element.

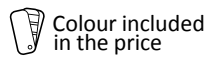

Legend



Available in chrome finish.



Radiator available in a "water" version.



Radiator suitable for dual fuel connection. Electric heating element can be installed.



Radiator available in electric only version. It comes prefilled with a 'heating medium' and equipped with a heating element. All tested and ready to use.



Connection types dedicated for this radiator.
The icon shows the flow and return connections for the radiator as well as the thermostat valve and heating element position if applicable.



Optional connections available for this radiator.



Suggested heating element power output for electric and dual fuel versions.



Weight.



Capacity.